



## SASLED Pendant / Surface Mounted

Functional offices should be defined with well developed lighting systems. Long-term performance, high energy efficiency and high visual comfort of LED systems are some of the requirements in these lighting projects.

SASLED luminaires have been developed by using SMD LED techniques that are highly efficient, and the good colour rendering provides advanced rendering light. Equipped with a specially designed diffuser, reflections and glares are eliminated from work surfaces and monitors. The 4000K light colour temperature provides motivating, homogeneous, and comfortable ambient lighting.

The Pendant model has a specially designed wire-locking mechanism so that height adjustment can be easily done. In lighting designs which require a following of the line axis, SASLED is ideal and gives lighting designers an opportunity to become more creative in their lighting designs. Recessed ceiling models for different ceiling types can make a room more exciting and appealing..



**SASLED PENDANT / SURFACE MOUNTED LED LUMINAIRE**

**Technical Specifications**

<b>Body</b>	: Painted steel sheet
<b>Diffuser</b>	: Special glare-controlled acrylic diffuser
<b>Power Consumption</b>	: 12W (30x30) / 18W (30x60) 28W (60x60) / 36W (60x60)
<b>Light Source</b>	: Chip LED
<b>Rated Voltage</b>	: 220-240 V 50-60 Hz
<b>Degree of Protection</b>	: IP 20
<b>Light Colour Temp.</b>	: 3000K Warm white, 4000K Neutral white 5000K Cool white
<b>Applications</b>	: General plasterboard ceiling, mineral ceiling, clip-in ceiling applications



Body Colour



RAL 9003

**Pendant Mounting**

4 pcs. 150cm. length steel wire ropes are included.

**Photometric Data**

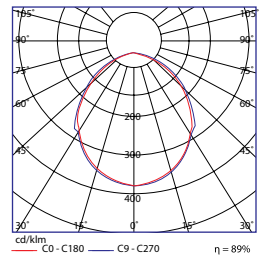

SASLED

**Technical Drawing**

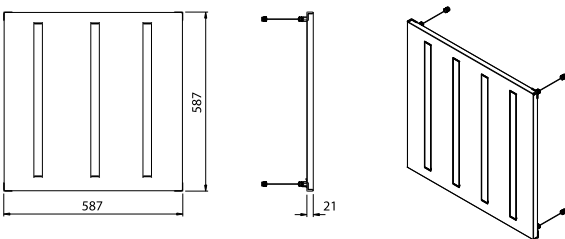

60x60 Sasled Pendant (3-4 Bar) Luminaire

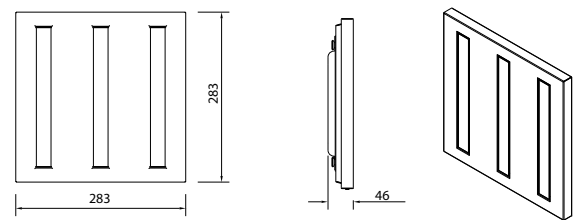

30x30 Sasled Mini Surface Mounted (3 Bar) Luminaire

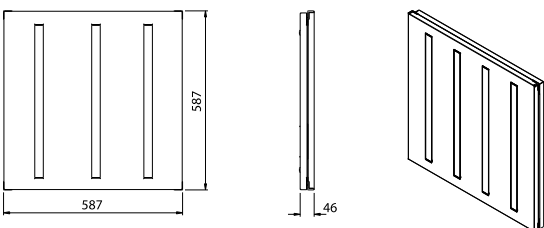

60x60 Sasled Surface Mounted (3-4 Bar) Luminaire

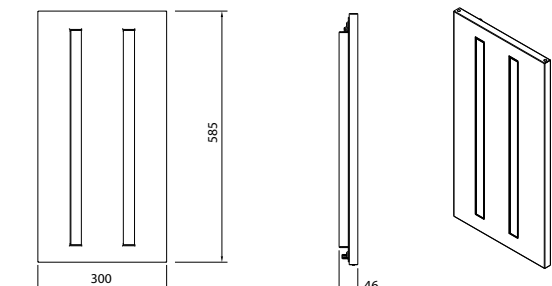

30x60 Sasled Mini Surface Mounted (2 Bar) Luminaire

**SASLED Pendant / Surface Ordering Table**

Ordering Code	Descriptions	Product Codes	Power Consumption (W)	Dimensions (mm) axbxh	Weight (kg)
41804	4*SASLED Surface Mounted (60x60) 5000K	JR2 4*C9U-PW/DF	36	587x587x46	4,75
41805	4*SASLED Pendant 50cm (60x60) 5000K	JR2 4*C9S-PW/DF	36	587x587x21	4,5
41806	4*SASLED Pendant 100cm (60x60) 5000K	JR2 4*C9S-PW/DF	36	587x587x21	4,5
41810	4*SASLED Surface Mounted (60x60) 4000K	JR2 4*C9U-NW/DF	36	587x587x46	4,75
41811	4*SASLED Pendant 50cm (60x60) 4000K	JR2 4*C9S-NW/DF	36	587x587x21	4,5
41812	4*SASLED Pendant 100cm (60x60) 4000K	JR2 4*C9S-NW/DF	36	587x587x21	4,5
41816	4*SASLED Surface Mounted (60x60) 3000K	JR2 4*C9U-WW/DF	36	587x587x46	4,75
41817	4*SASLED Pendant 50cm (60x60) 3000K	JR2 4*C9S-WW/DF	36	587x587x21	4,5
41818	4*SASLED Pendant 100cm (60x60) 3000K	JR2 4*C9S-WW/DF	36	587x587x21	4,5
41822	4*SASLED Surface Mounted (60x60) 3000K	JR2 4*C70-WW/DF	28	587x587x46	4,75
41823	4*SASLED Pendant 50cm (60x60) 3000K	JR2 4*C7S-WW/DF	28	587x587x21	4,5
41824	4*SASLED Pendant 100cm (60x60) 3000K	JR2 4*C7S-WW/DF	28	587x587x21	4,5
41828	4*SASLED Surface Mounted (60x60) 4000K	JR2 4*C70-NW/DF	28	587x587x46	4,75
41829	4*SASLED Pendant 50cm (60x60) 4000K	JR2 4*C7S-NW/DF	28	587x587x21	4,5
41830	4*SASLED Pendant 100cm (60x60) 4000K	JR2 4*C7S-NW/DF	28	587x587x21	4,5
41834	4*SASLED Surface Mounted (60x60) 5000K	JR2 4*C70-PW/DF	28	587x587x46	4,75
41835	4*SASLED Pendant 50cm (60x60) 5000K	JR2 4*C7S-PW/DF	28	587x587x21	4,5
41836	4*SASLED Pendant 100cm (60x60) 5000K	JR2 4*C7S-PW/DF	28	587x587x21	4,5
41840	3*SASLED Surface Mounted (60x60) 3000K	JR2 3*C9U-WW/DF	28	587x587x46	1,75
41841	3*SASLED Pendant 50cm (60x60) 3000K	JR23*C9S-WW/DF	28	587x587x21	1,75
41842	3*SASLED Pendant 100cm (60x60) 3000K	JR23*C9S-WW/DF	28	587x587x21	1,75
41846	3*SASLED Surface Mounted (60x60) 4000K	JR2 3*C9U-NW/DF	28	587x587x46	1,75
41847	3*SASLED Pendant 50cm (60x60) 4000K	JR2 3*C9S-NW/DF	28	587x587x21	1,75
41848	3*SASLED Pendant 100cm (60x60) 4000K	JR2 3*C9S-NW/DF	28	587x587x21	1,75
41852	3*SASLED Surface Mounted (60x60) 5000K	JR2 3*C9U-PW/DF	28	587x587x46	1,75
41853	3*SASLED Pendant 50cm (60x60) 5000K	JR2 3*C9S-PW/DF	28	587x587x21	1,75
41854	3*SASLED Pendant 100cm (60x60) 5000K	JR2 3*C9S-PW/DF	28	587x587x21	1,75
41864	3*SASLED Surface Mounted (30x30) 3000K	JR2 3*C3U-WW/DF	12	283x283x46	1,75
41865	3*SASLED Surface Mounted (30x30) 4000K	JR2 3*C3U-NW/DF	12	283x283x46	1,75
41866	3*SASLED Surface Mounted (30x30) 5000K	JR2 3*C3U-PW/DF	12	283x283x46	1,75
41869	2*SASLED Surface Mounted (30x60) 3000K	JR2 2*C9U-WW/DF	18	585x300x44	2,5
41872	2*SASLED Surface Mounted (30x60) 4000K	JR2 2*C9U-NW/DF	18	585x300x44	2,5
41875	2*SASLED Surface Mounted (30x60) 5000K	JR2 2*C9U-PW/DF	18	585x300x44	2,5

