

BLOOM 60x60 (IP65)

CLEAN ROOM LUMINAIRE

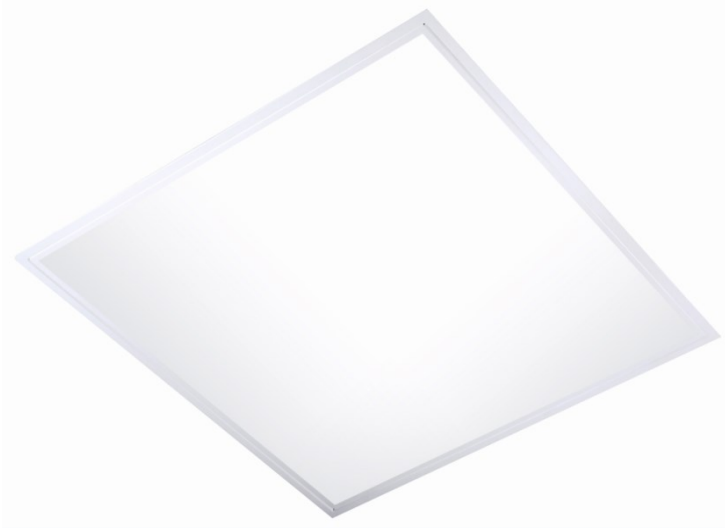

Technical Features

Body	: Powder Finished Sheet Steel
Diffuser	: Opal Acrylic
Rated Power	: 38 W
Light Source	: 60x60 SMD LED
Input Voltage	: 220V - 240V 50-60 Hz
Driver / Ballast	: Cos ϕ > 0,9
IP Protection	: IP 65
Light Color	: Naturel White, Warm White, Pure White
CRI	: min.80
Installation	: Plaster, Rockwool, Clip-in ceiling application

Technical Drawings

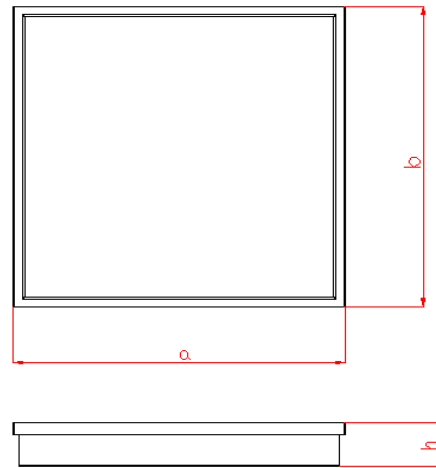

Ordering Information

Order Code	Description	Product Code	Power Consumption (W)	Dimensions (mm) axbxh
40402	ROCKWOOL 3000K, OPAL DIFFUSER	BL 360*C2T-WW/OD IP65	38W	595 x 595 x 87
40403	ROCKWOOL 4000K, OPAL DIFFUSER	BL 360*C2T-NW/OD IP65	38W	595 x 595 x 87
40404	ROCKWOOL 5000K, OPAL DIFFUSER	BL 360*C2T-PW/OD IP65	38W	595 x 595 x 87
40405	PLASTER 3000K, OPAL DIFFUSER	BL 360*C2A-WW/OD IP65	38W	595 x 595 x 87
40406	PLASTER 4000K, OPAL DIFFUSER	BL 360*C2A-NW/OD IP65	38W	595 x 595 x 87
40407	PLASTER 5000K, OPAL DIFFUSER	BL 360*C2A-PW/OD IP65	38W	595 x 595 x 87
40408	CLIP-IN 3000K, OPAL DIFFUSER	BL 360*C2C-WW/OD IP65	38W	588 x 588 x 87
40409	CLIP-IN 4000K, OPAL DIFFUSER	BL 360*C2C-NW/OD IP65	38W	588 x 588 x 87
40411	CLIP-IN 5000K, OPAL DIFFUSER	BL 360*C2C-PW/OD IP65	38W	588 x 588 x 87
40453	ROCKWOOL 3000K, WITH GLASS	BL 360*C2T-WW/CM IP65	38W	595 x 595 x 87
40454	ROCKWOOL 4000K, WITH GLASS	BL 360*C2T-NW/CM IP65	38W	595 x 595 x 87
40455	ROCKWOOL 5000K, WITH GLASS	BL 360*C2T-PW/CM IP65	38W	595 x 595 x 87
40456	PLASTER 3000K, WITH GLASS	BL 360*C2A-WW/CM IP65	38W	595 x 595 x 87
40457	PLASTER 4000K, WITH GLASS	BL 360*C2A-NW/CM IP65	38W	595 x 595 x 87
40458	PLASTER 5000K, WITH GLASS	BL 360*C2A-PW/CM IP65	38W	595 x 595 x 87
40459	CLIP-IN 3000K, WITH GLASS	BL 360*C2C-WW/CM IP65	38W	588 x 588 x 87
40460	CLIP-IN 4000K, WITH GLASS	BL 360*C2C-NW/CM IP65	38W	588 x 588 x 87
40461	CLIP-IN 5000K, WITH GLASS	BL 360*C2C-PW/CM IP65	38W	588 x 588 x 87